

How to create, adjust, and remove pens?

1. Log in on a desktop device with your credentials to app.feedlync.com.

In the side navigation click Feed Management, and select Pens.

To register a new pen, in the top navigation select New +.

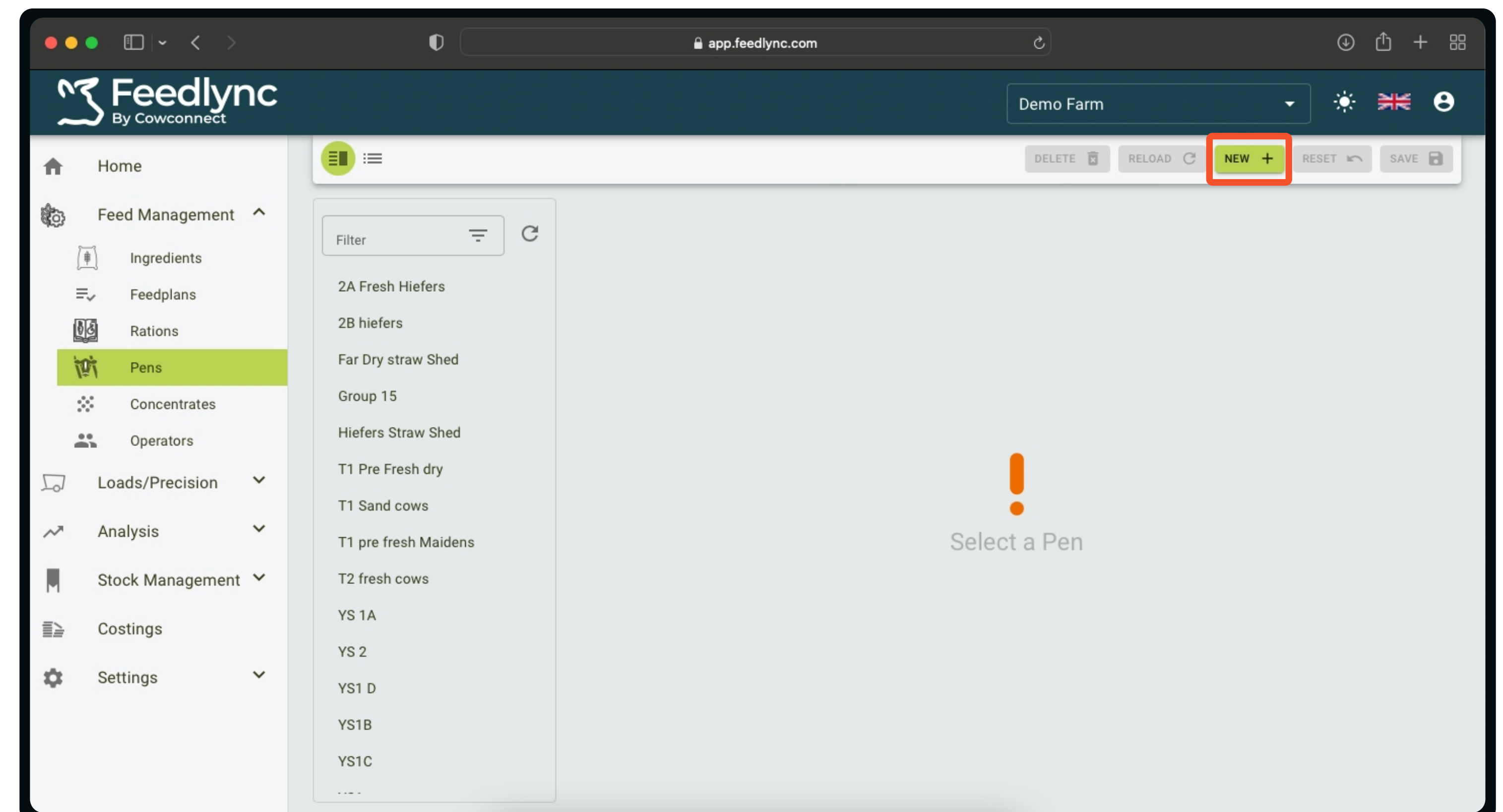

2. Name your pen.

The following fields are required:

Name,

Number of animals,

Pen Type,

Pen Sub-type.

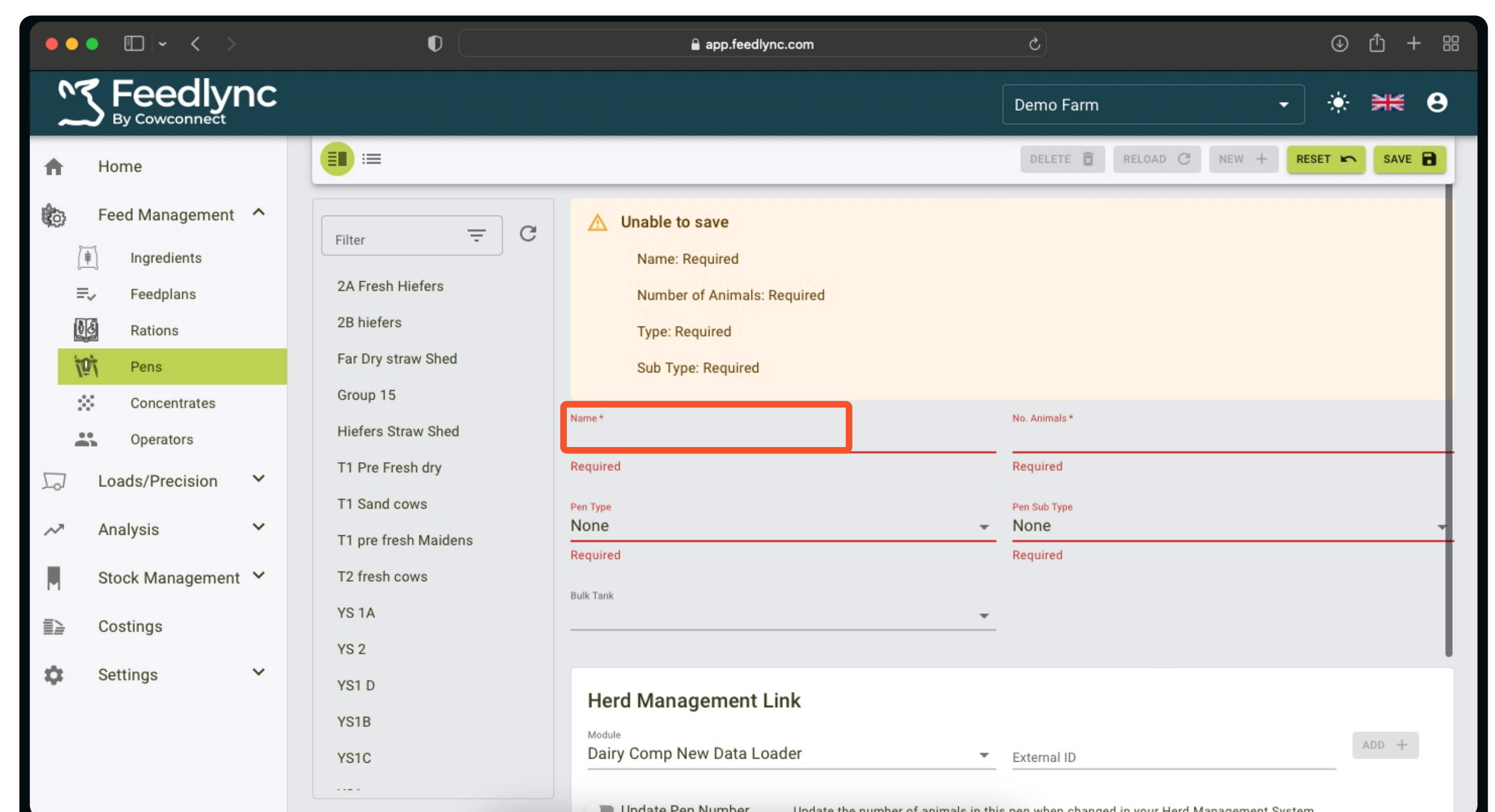

3. Save.

By repeating step 1 and 2, you can create more pens.

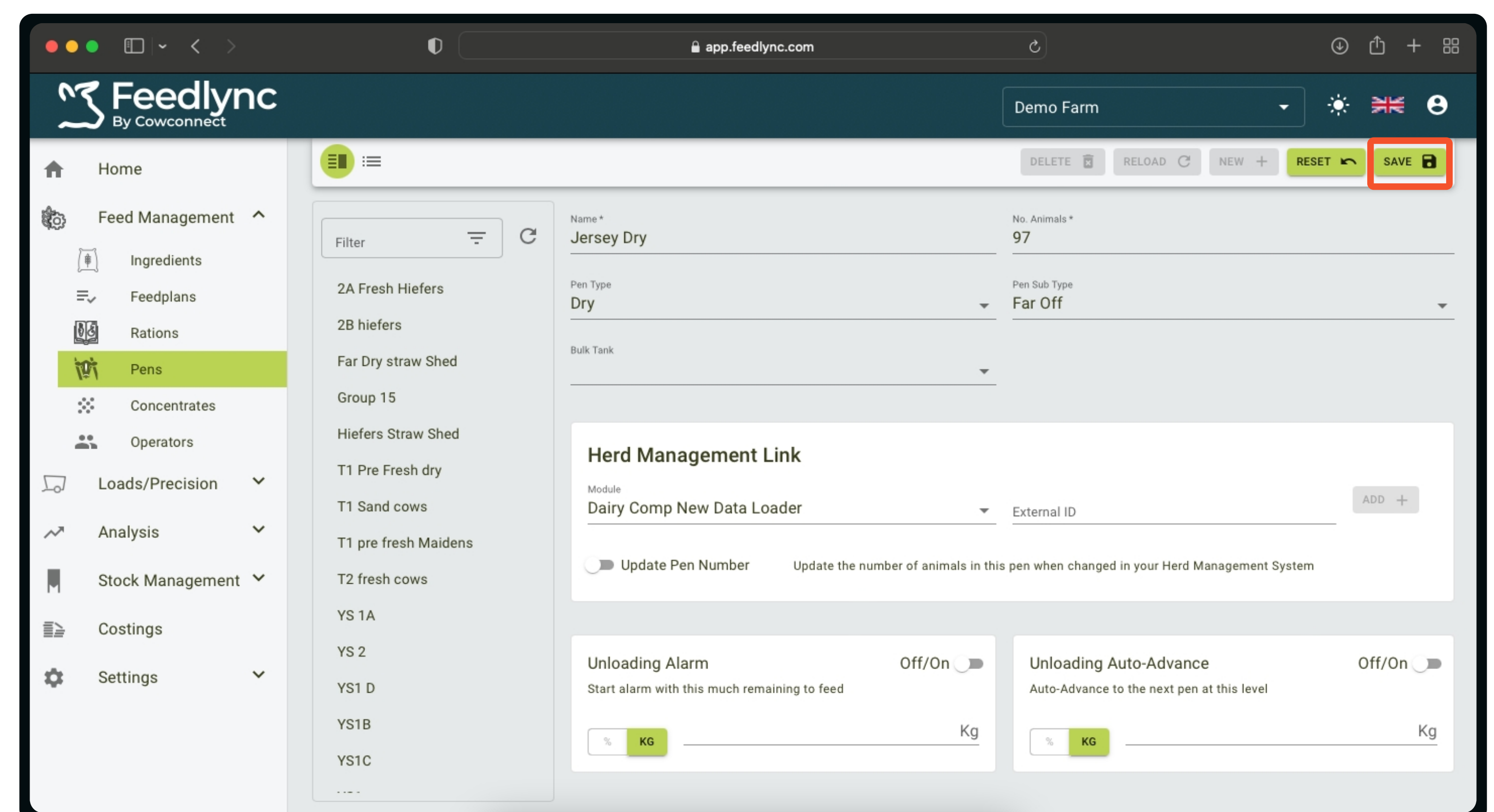

4. Adjust the information, such as animal numbers, by clicking into the field you would like to change.

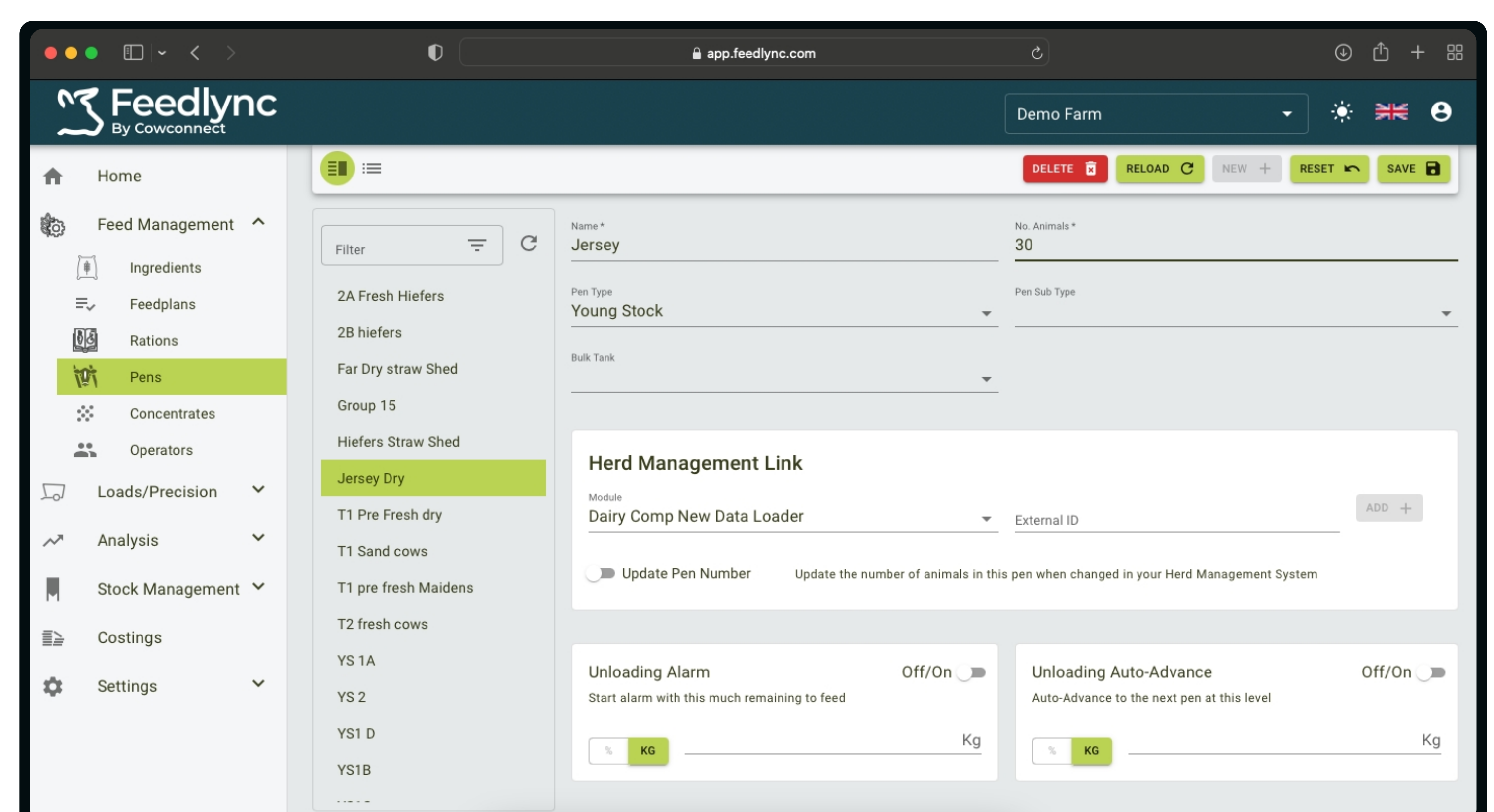

How to create, adjust, and remove pens?

5. Reset options to roll back changes.

If you have made changes in an existing group, that you do not wish to save, by clicking Reset, you'll be able to roll them back.

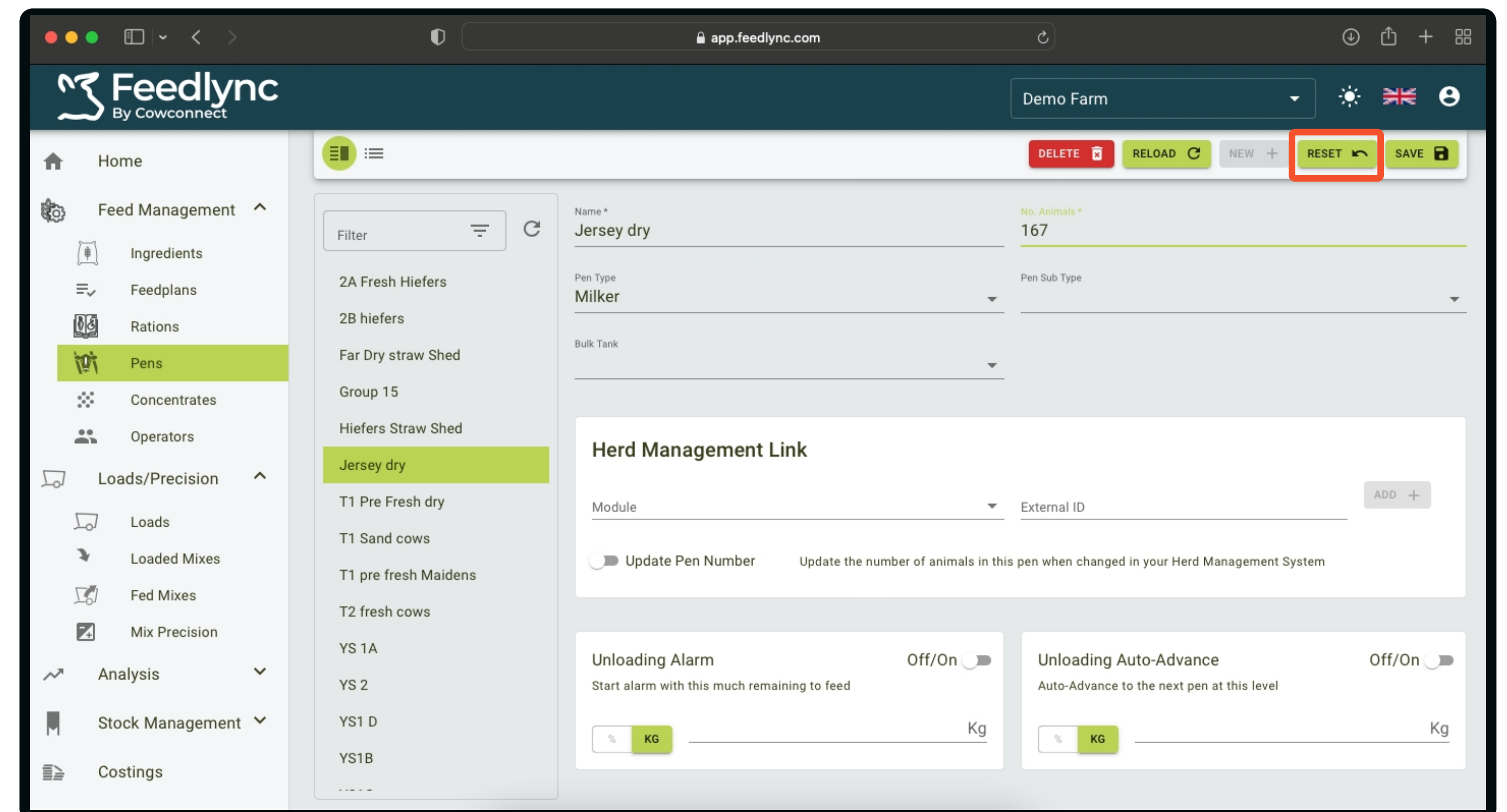

6. If the group no longer exist on the farm, you can delete it from the list.

Select the name of the group and click Delete in the top navigation and confirm.

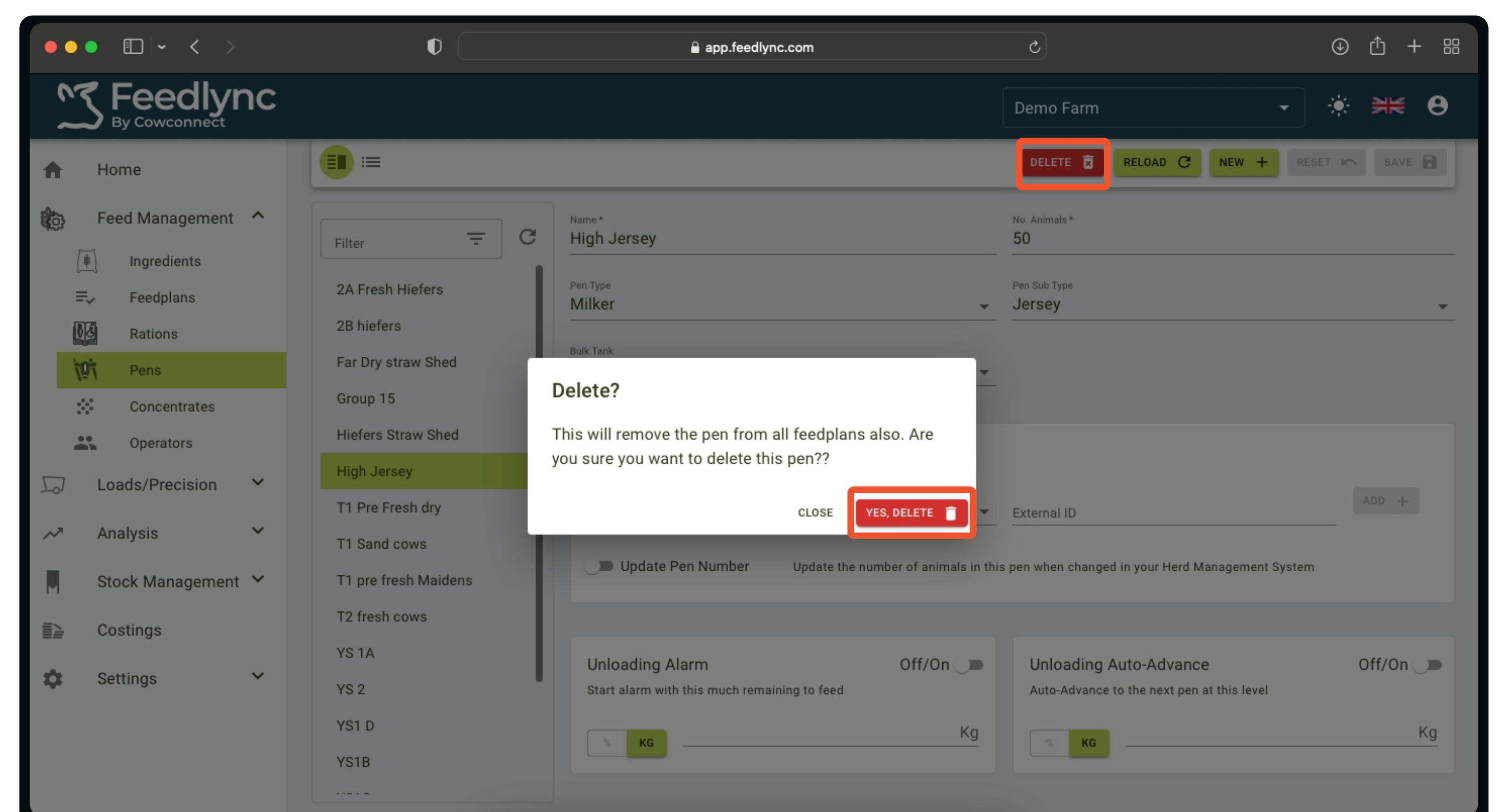

Contact
www.feedlync.com
support@feedlync.com
 US (+1) 414 939 6871
 UK (+44) 20 3966 90 63
 DK (+45) 32 25 89 56