

How to calibrate the Feedlync system and the wagon?

1. Log in to the Feedlync app using your credentials.

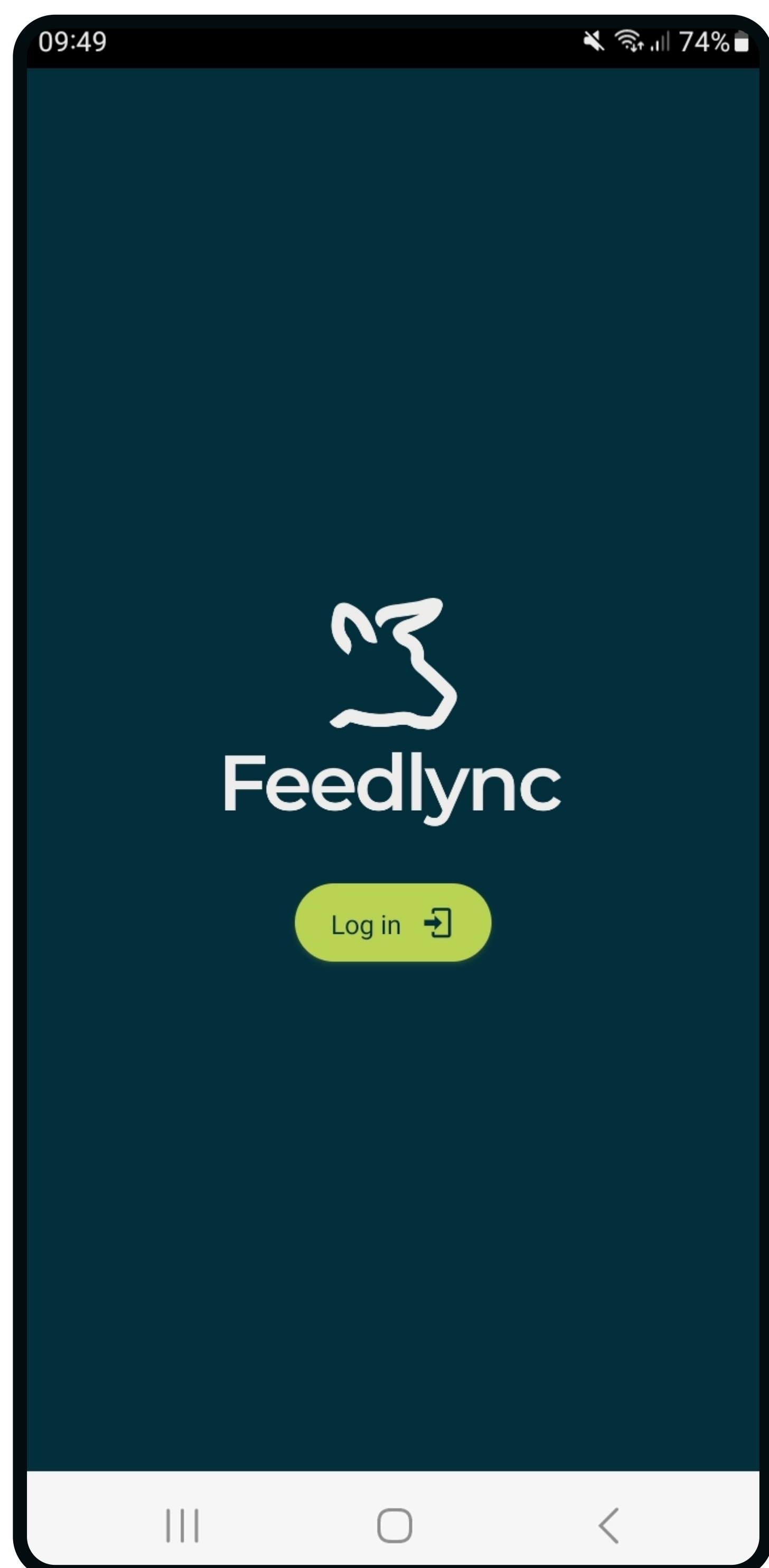

2. Tap the menu icon.

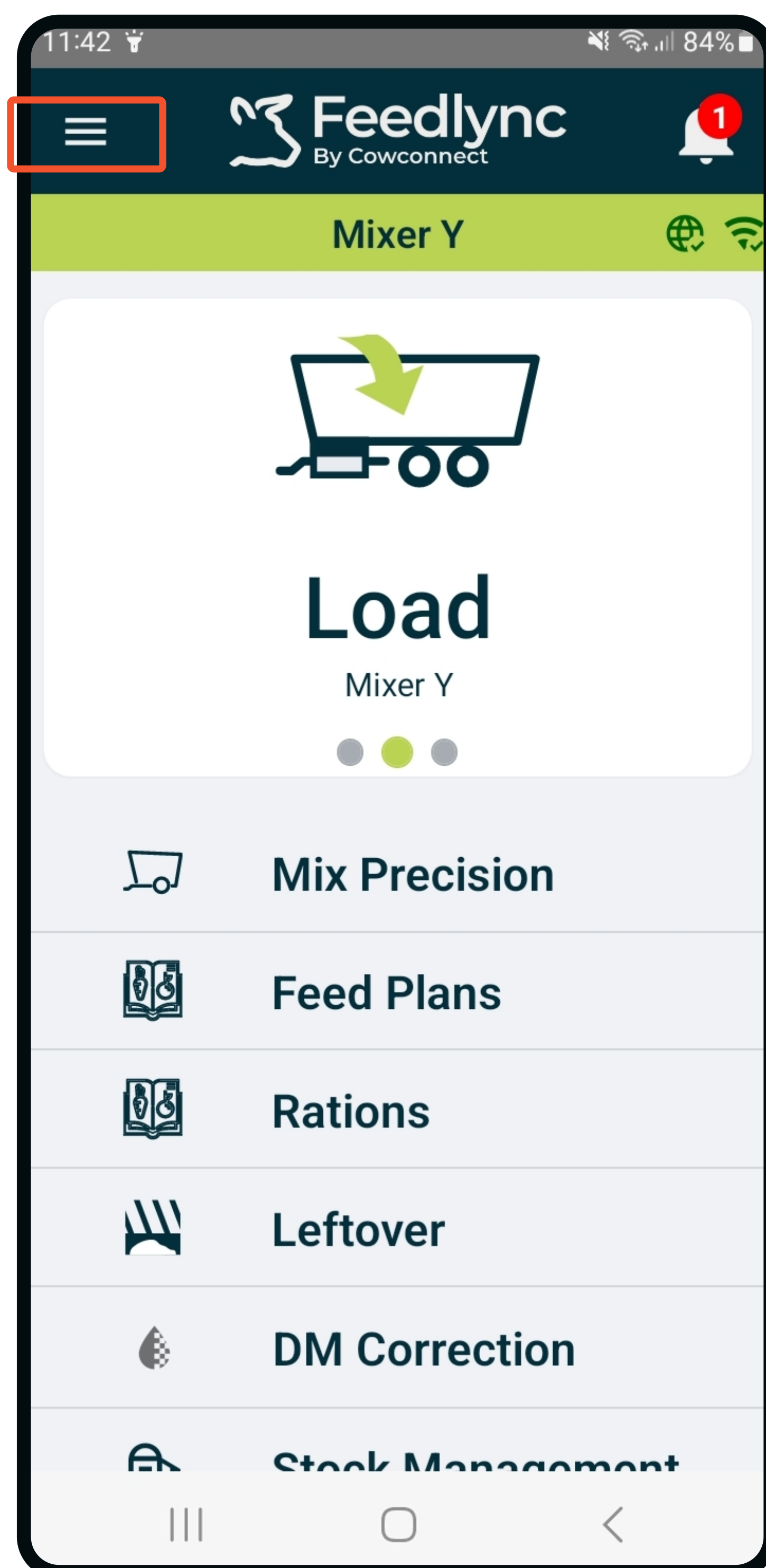

3. Select the cog icon.

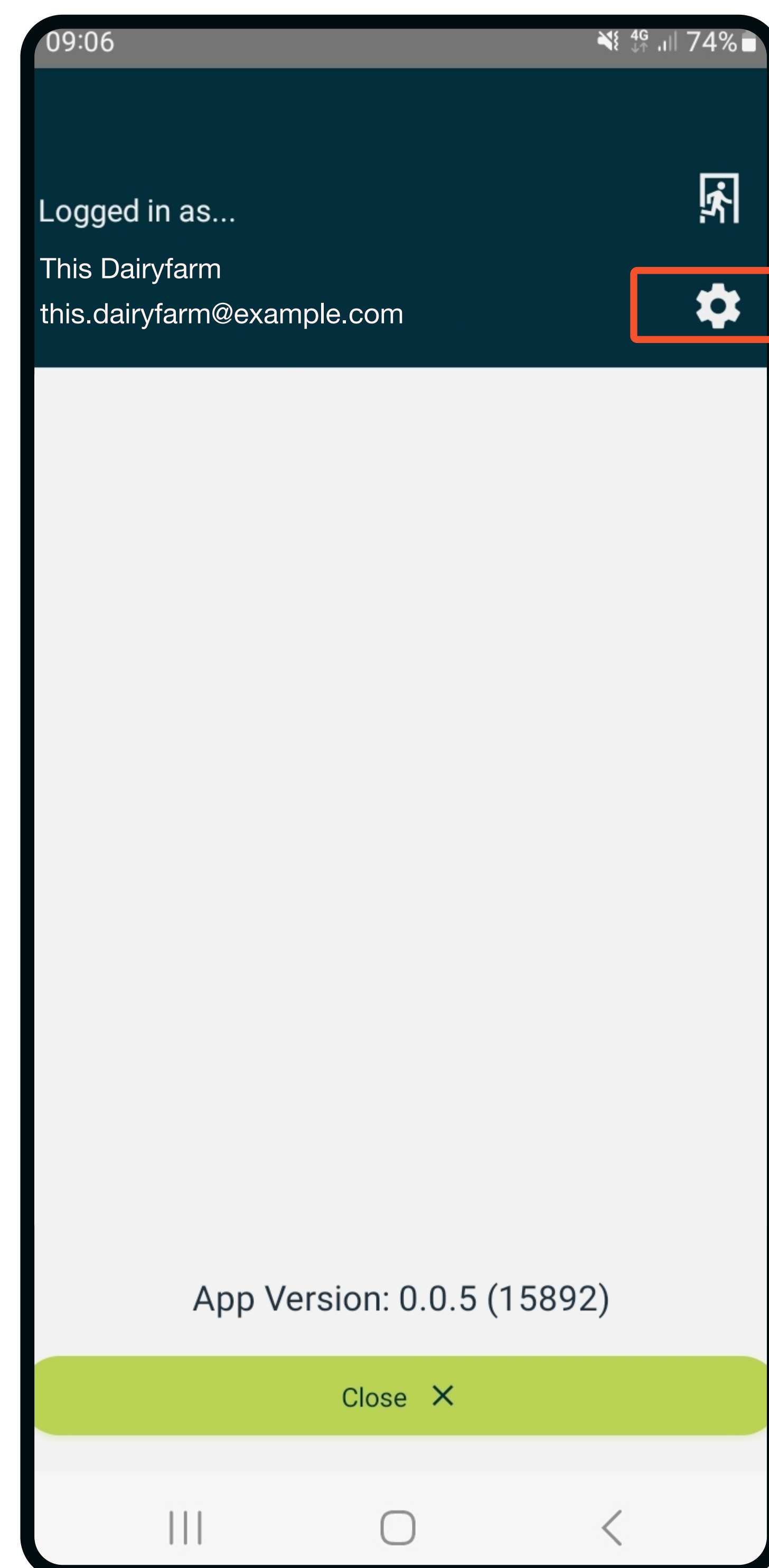

4. Then choose Device Settings.

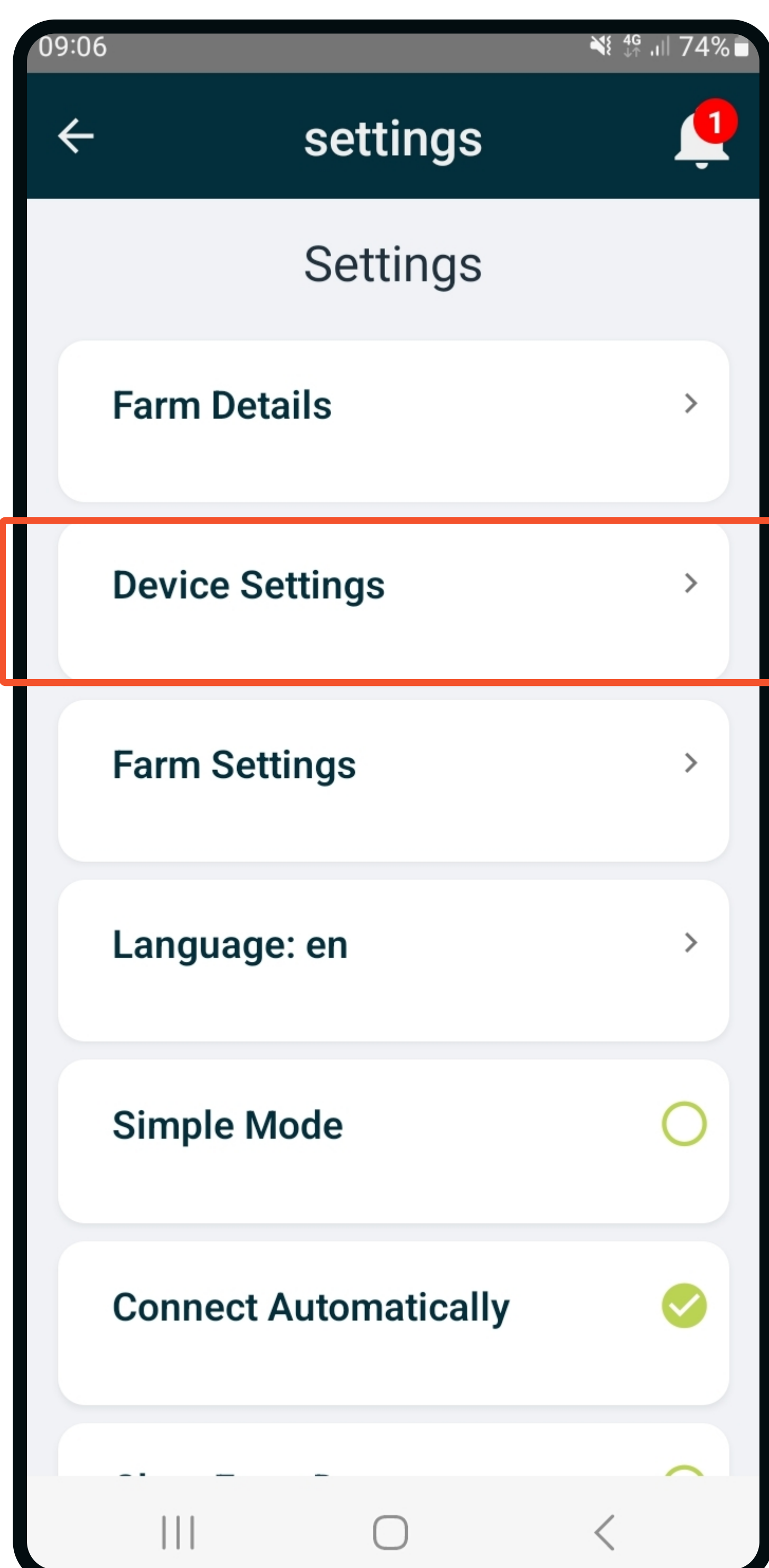

5. Ready to calibrate device.

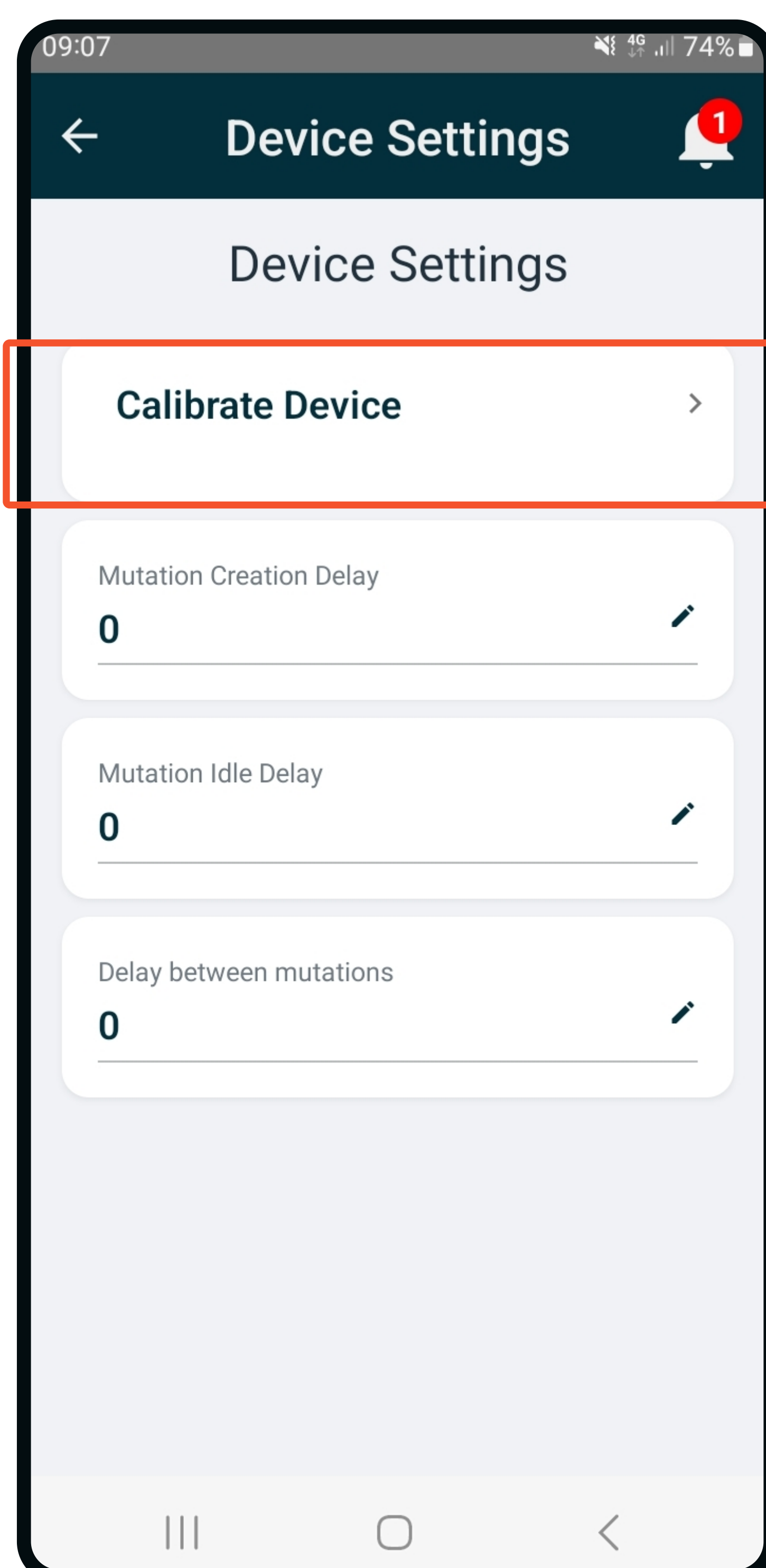

While the wagon is empty,
standing on flat ground..

How to calibrate the Feedlync system and the wagon?

6. Get Empty Uvolt.
Hang a test load on the wagon.

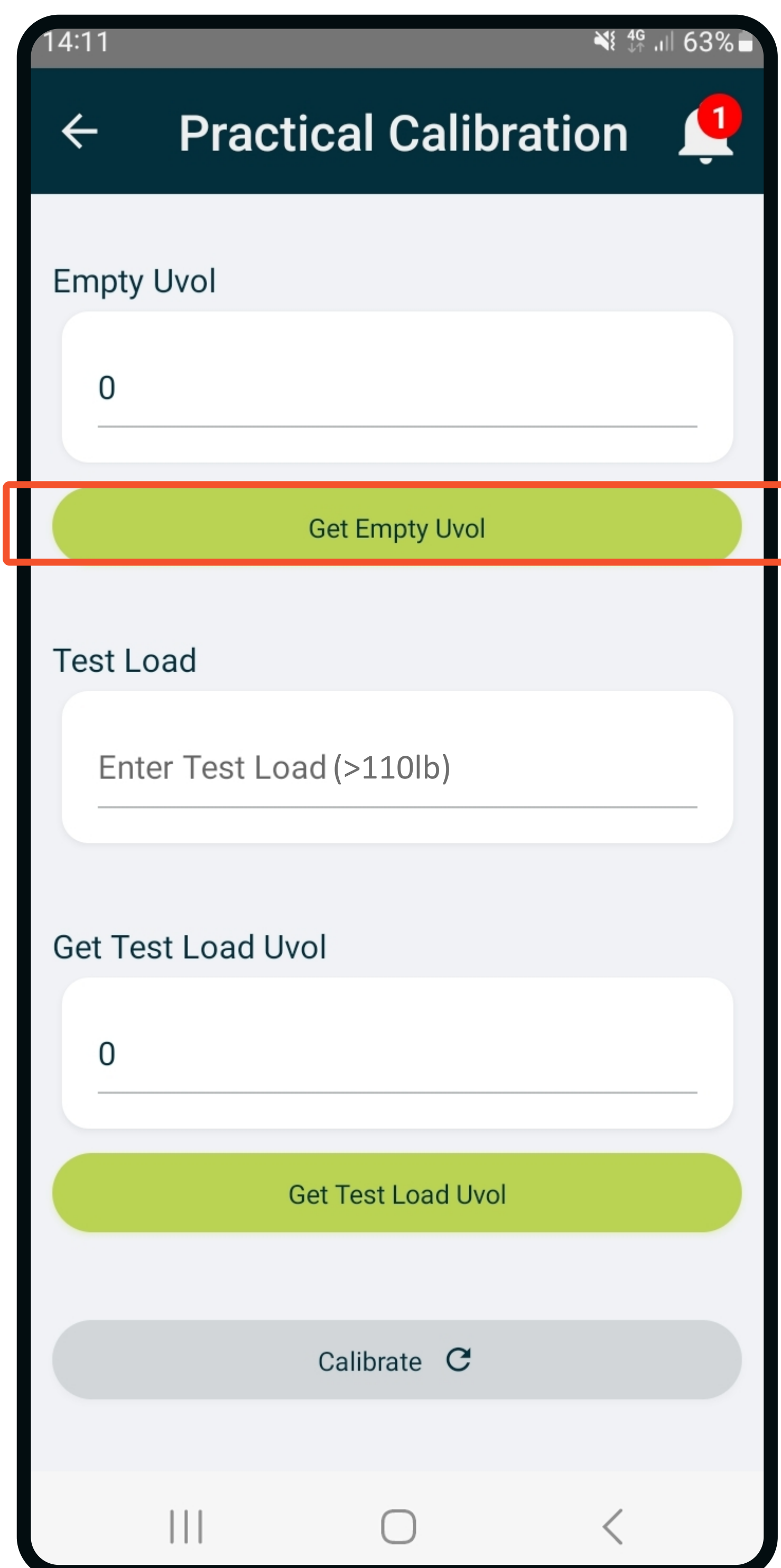

14:11

← Practical Calibration 1

Empty Uvol

0

Get Empty Uvol

Test Load

Enter Test Load (>110lb)

Get Test Load Uvol

0

Get Test Load Uvol

Calibrate ↻

Use a testload, where you know the precise weight.
Distribute the test weight directly on the weight cells.
Enter the weight in the field "Test Load".

7. Get Test Load Uvolt, and press calibrate.

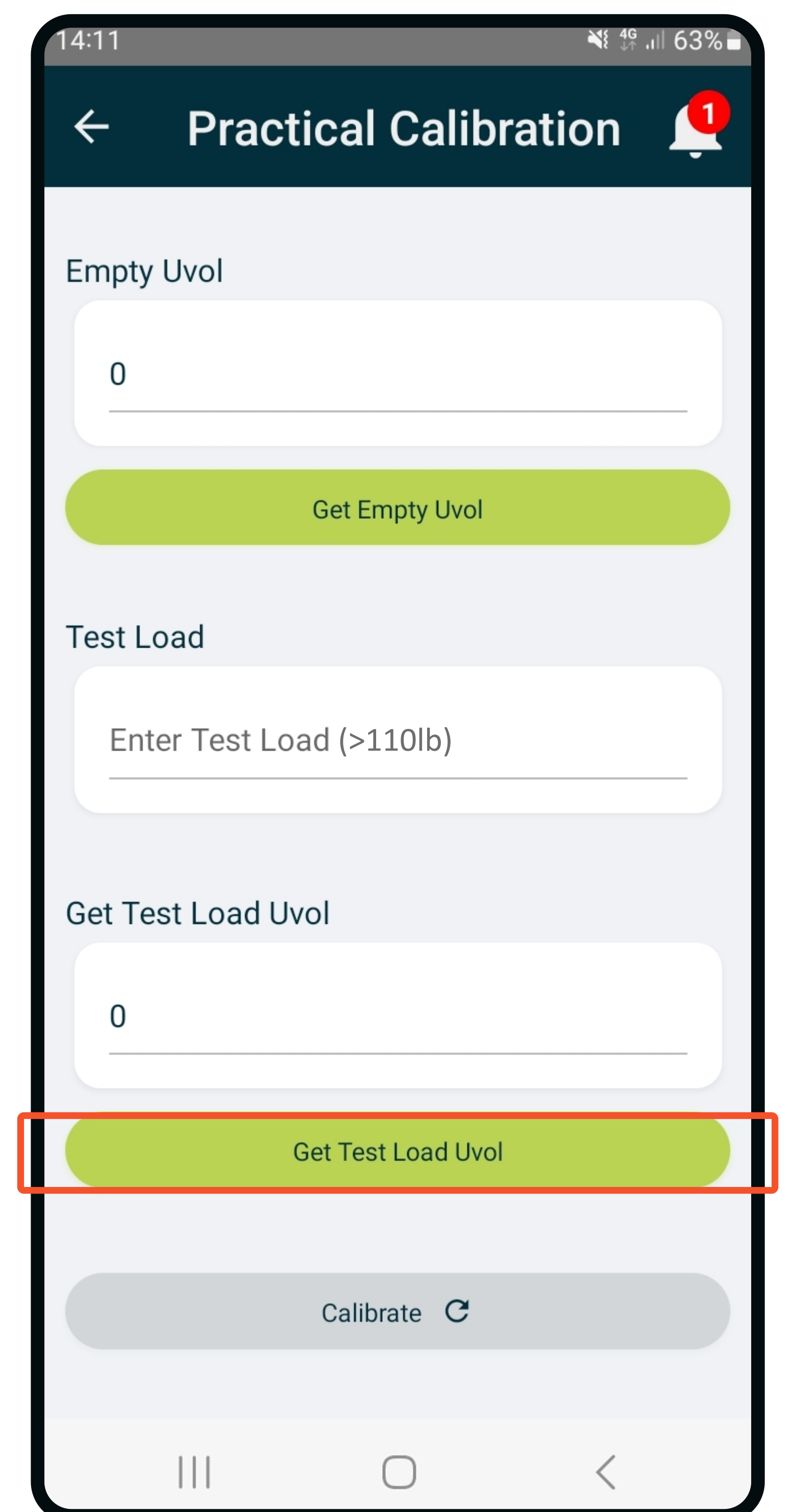

14:11

← Practical Calibration 1

Empty Uvol

0

Get Empty Uvol

Test Load

Enter Test Load (>110lb)

Get Test Load Uvol

0

Get Test Load Uvol

Calibrate ↻

8. Calibration done.

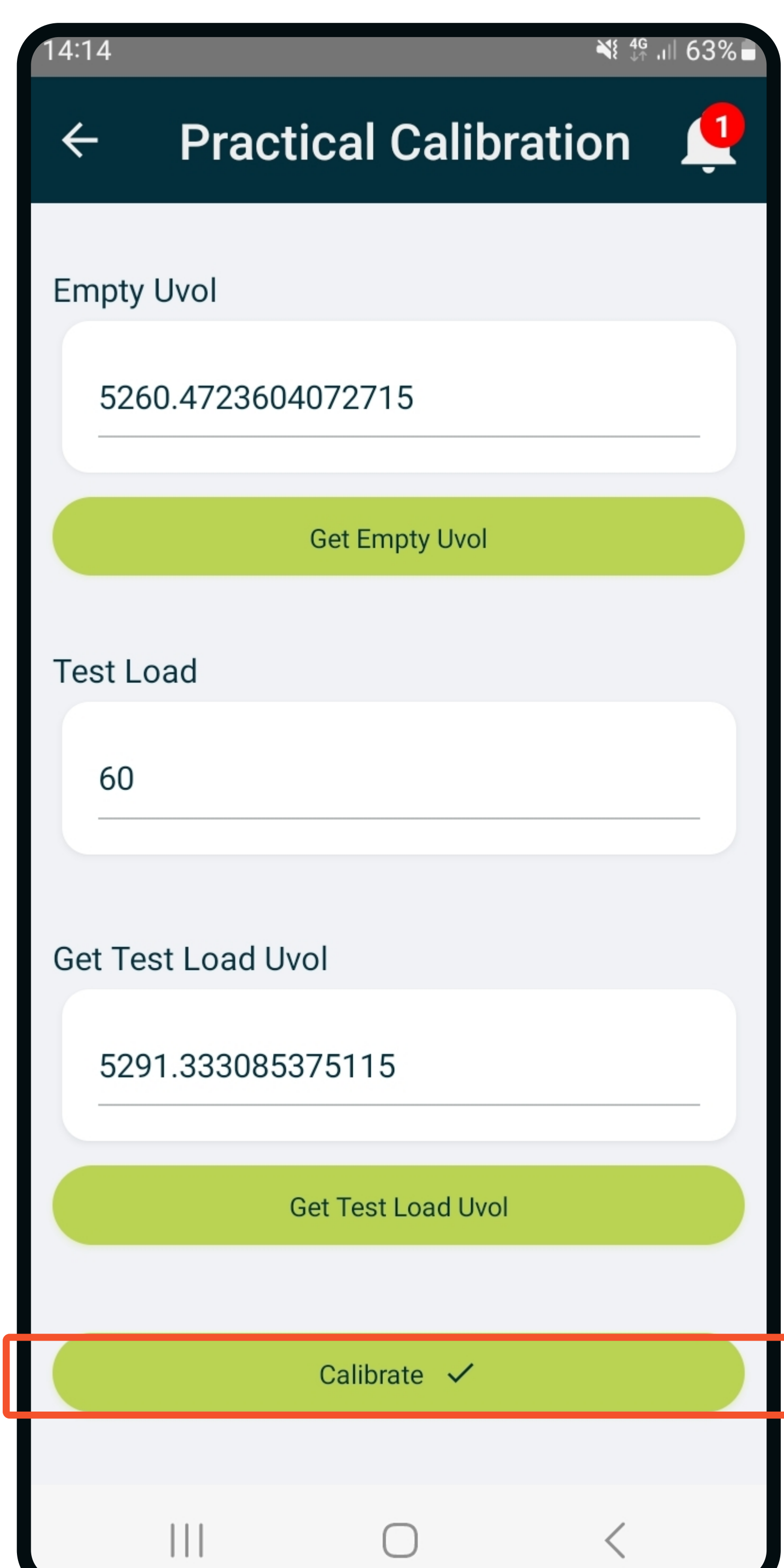

14:14

← Practical Calibration 1

Empty Uvol

5260.4723604072715

Get Empty Uvol

Test Load

60

Get Test Load Uvol

5291.333085375115

Get Test Load Uvol

Calibrate ✓

8. You are ready to start feeding.

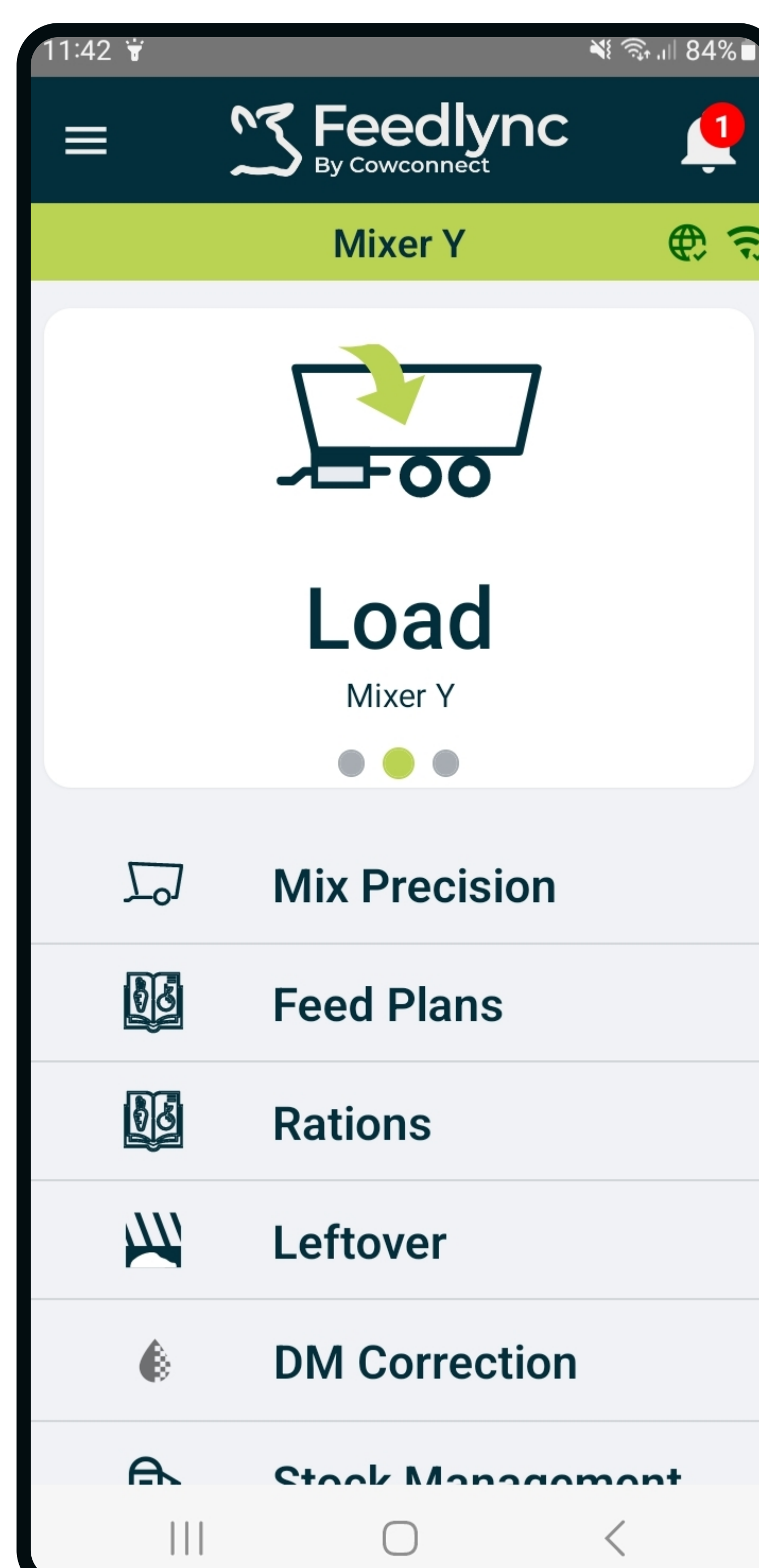

11:42

Feedlync By Cowconnect 1

Mixer Y

Load

Mixer Y

Mix Precision

Feed Plans

Rations

Leftover

DM Correction

Stock Management

Contact
www.feedlync.com
support@feedlync.com
 US (+1) 414 939 6871
 UK (+44) 20 3966 90 63
 DK (+45) 32 25 89 56