

QUICK SETUP GUIDE

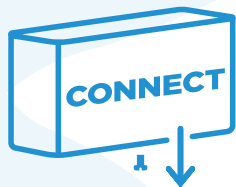

1

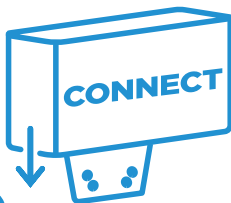

2

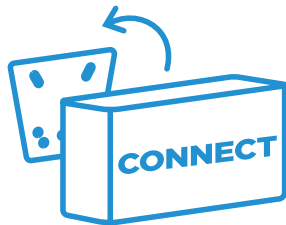

3

Note: Video guide for installation scan QR code

1. Remove screw from the bottom of the Gateway
2. Slide off the bracket from the Gateway -
If necessary use the screwdriver to do so
3. Mount the bracket on the mixer wagon, put the Gateway on and tighten the screw in the bottom



ANALOG GATEWAY SETUP

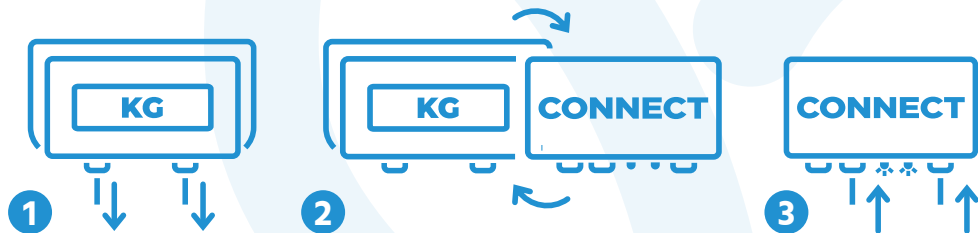

Important: Make sure no power is on the tractor

1. Unplug cables of weight display
2. Dismount weight display and mount Cowconnect as discribed on the front page
3. Plug the same cables into Cowconnect gateway
4. Wait 30 seconds, 2 green lights will appear

Note: *A calibration is needed before usage - Scan QR for instructions*



SERIAL GATEWAY SETUP

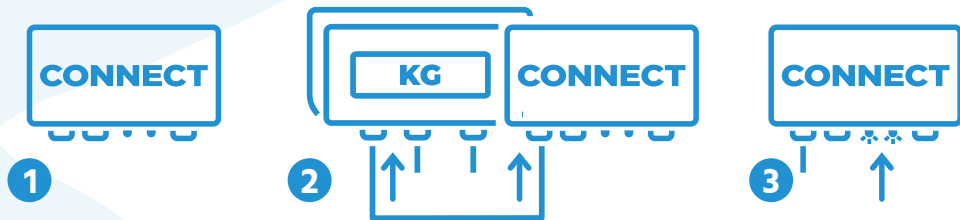

Important: Make sure no power is on the tractor

1. Mount Cowconnect with included bracket
2. Plug in the SERIAL cable between SERIAL output of the weight indicator and SERIAL input of the Cowconnect gateway
3. Wait 30 seconds, 2 green lights will appear

Note: *May require contact with support to finalize setup*

SCHEMATIC FOR SETUP

Analog

Cable	Junction box
RED	EXC +
BLACK	EXC -
GREEN	SIG +
WHITE	SIG -
TRANSPARENT	SHIE

Serial

Display	Cowconnect
TX	GREEN
12 V	RED
GND	BLACK
RX	WHITE
SHIELD	TRANSPARENT

Contact support at

+44 20 3966 90 63

Support@cowconnect.com